

Gorgeous Remodeled Townhome Located in Desirable Warther Neighborhood



206 Whitcliff Court | Gaithersburg, MD 20878



CHRIS NAGEL

Ranked in the Top 3% of Realtors Nationwide

www.ChrisNagelHomes.com

Office: 301-340-8700 x155
Mobile: 301-787-8001
Chris@Coakleyrealty.com

Office: 301-340-8700 x103
Mobile: 301-814-3200
MPRose57@aol.com



MICHAEL P. ROSE

Ranked in the Top 1% of Realtors Nationwide

www.MichaelPRose.com



Gorgeous remodeled 3BR/2FB/2HB townhome located in sought after Warther neighborhood. This home features approximately 2,000 square feet of living area on three levels including a great sense of light and spaciousness with designer home appeal.

Foyer entrance with new storm door, coat closet and adjacent updated powder room; living room with hardwood flooring and recessed lighting; remodeled gourmet kitchen featuring hardwood flooring, cherry cabinetry with additional prep area, granite countertops with undermount sink, stainless steel appliances and pantry; separate dining area with pass through to kitchen, chair and crown moulding, hardwood flooring, chandelier and newer sliding glass door to back deck; spacious master bedroom suite with neutral carpeting, walk-in closet with custom built-in's and ceiling fan with light; updated master bath with designer ceramic tile flooring and walk-in shower with glass door enclosure; two additional bedrooms on upper level with neutral carpeting and update full bath with tub/shower.

Fully-finished lower level recreation room with neutral carpet and half bath; separate utility room with LG front load washer and dryer and additional storage; fully fenced-in rear yard with enormous deck perfect for entertaining. Two assigned parking spaces in front #206. Neighborhood amenities include Green Park tot lots/playground, tennis courts, dog park and jogging/walking paths. Conveniently located close to I-270/370(ICC), metro commuter routes and downtown Crown and Rio, Kentlands retail/restaurants and shopping.



Chris Nagel



Michael P. Rose

Main Level

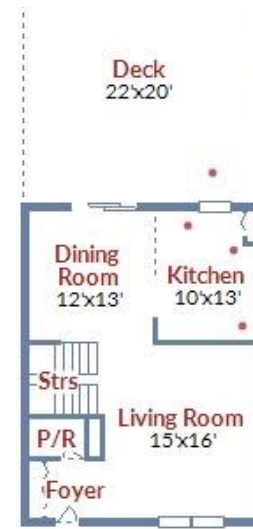

Upper Level



Lower Level

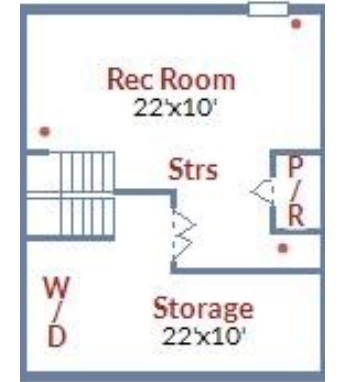

- Year Built:** 1982
- Legal Subdivision:** Warther
- Est. RE Taxes:** 4,780.28 (FY 2020)
- Lot Size:** 1,980 Square Feet
- Exterior:** Siding
- Heat:** Gas
- Cool:** Electric
- Hot water:** Gas • 50-gallon
- HOA Fee:** \$55.00 per month

- Elementary School**
Fields Road
- Middle School**
Ridgeview
- High School**
Quince Orchard

Information in this brochure is deemed to be accurate, but should not be relied upon without verification.

